

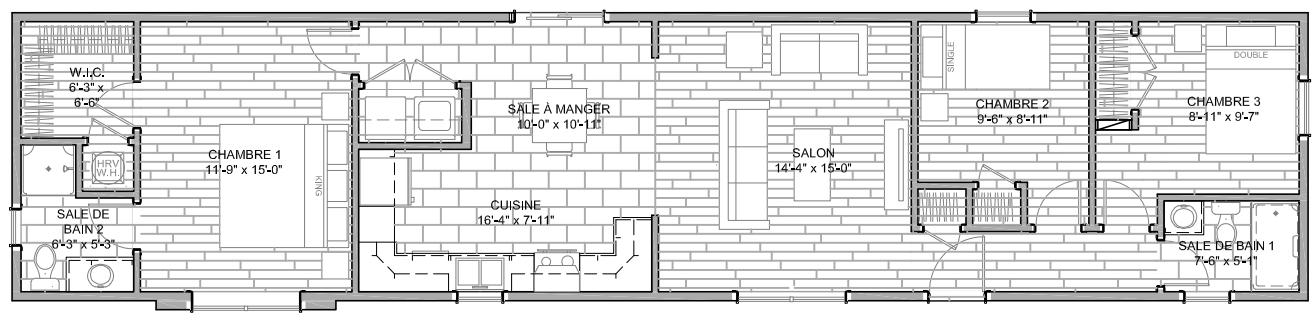

**FB18** - 3 CHAMBRES - 2 SALLES DE BAINS  
 - 16'-0" x 72'-0" HORS-TOUT, 1152 P.C. ESPACE HABITABLE  
 - SALLE DE BAIN ATTENANTE  
 - WALK-IN CLOSET



☎ 1.800.561.8066

WWW.SUPREMEHOMES.CA

**CONVENTIONNEL**

PLANS AND IMAGES ARE EXAMPLES, THE FINAL PRODUCT MAY VARY  
 © COPYRIGHT 2023 SUPREME HOMES, ALL RIGHTS RESERVED