

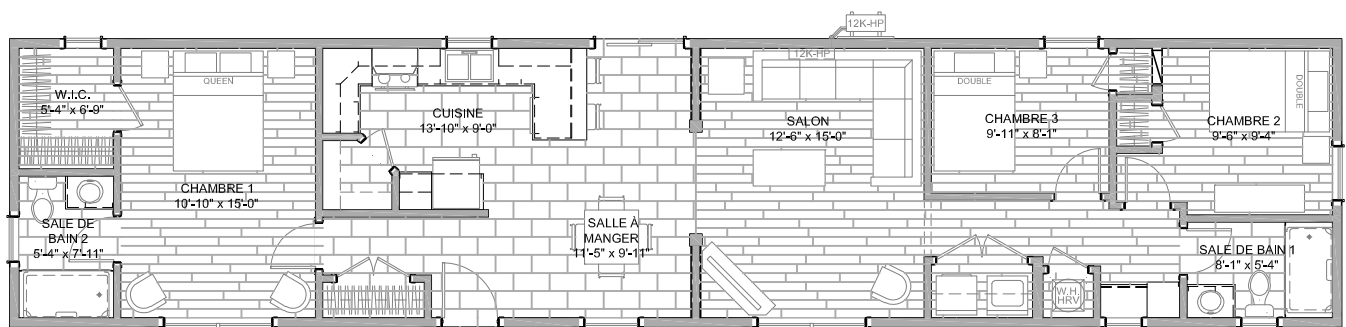

- FBO1** - 3 CHAMBRES - 2 SALLES DE BAINS
- 16'-0" x 74'-0" HORS-TOUT, 1 184 P.C. ESPACE HABITABLE
 - SALLE DE BAIN ATTENANTE
 - WALK-IN-CLOSET
 - PANTRY



☎ 1.800.561.8066

WWW.SUPREMEHOMES.CA

CONVENTIONNEL

PLANS AND IMAGES ARE EXAMPLES, THE FINAL PRODUCT MAY VARY

© COPYRIGHT 2023 SUPREME HOMES, ALL RIGHTS RESERVED